

PLAYGROUND

SOUTH RUSSELL VILLAGE PARK

1000 BELL ST. SOUTH RUSSELL, OHIO 44022

JANUARY 2019

PREPARED FOR:
SOUTH RUSSELL VILLAGE

5205 CHILLICOTHE ROAD
SOUTH RUSSELL, OHIO 44022
(440) 338-6700

PREPARED BY:
CT CONSULTANTS

ENGINEERS | ARCHITECTS | PLANNERS
8150 STERLING CT
MENTOR, OHIO 44060
(440) 951-9000

INDEX OF DRAWINGS

SD-1	SITE LAYOUT PLAN
SD-2	PLAYGROUND LAYOUT
L-1	LANDSCAPE PLAN
SWPP-1	STORMWATER POLLUTION PREVENTION PLAN



LOCATION MAP
NOT TO SCALE



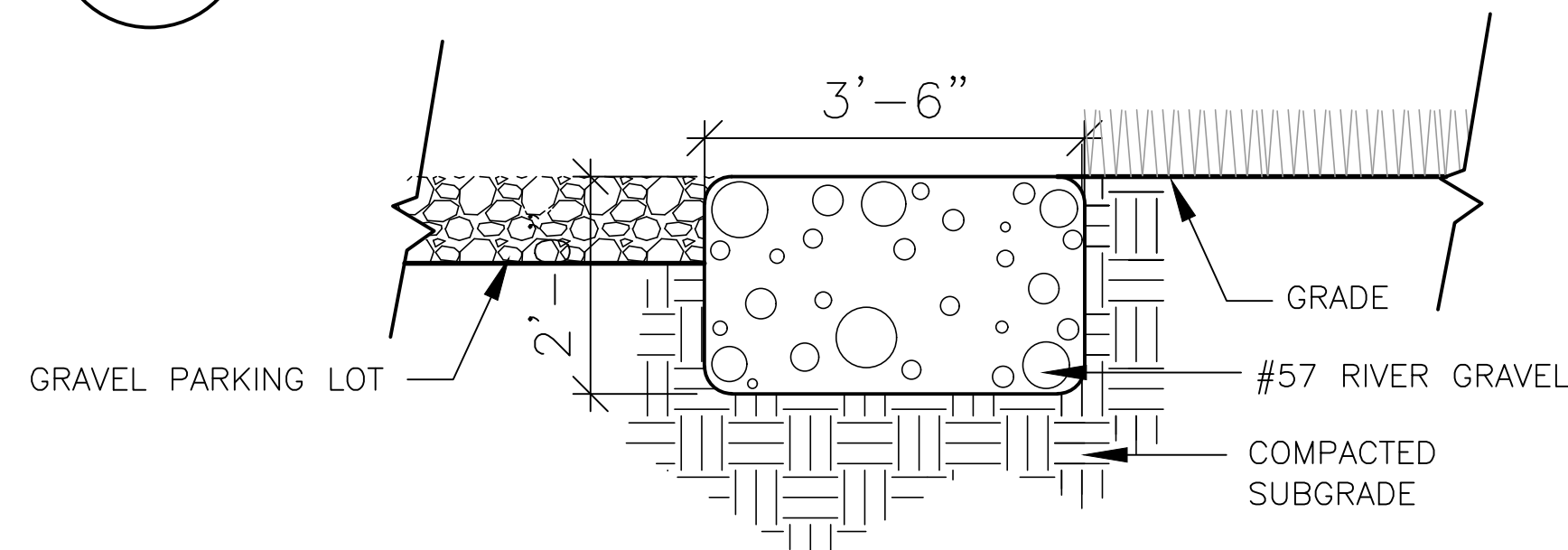
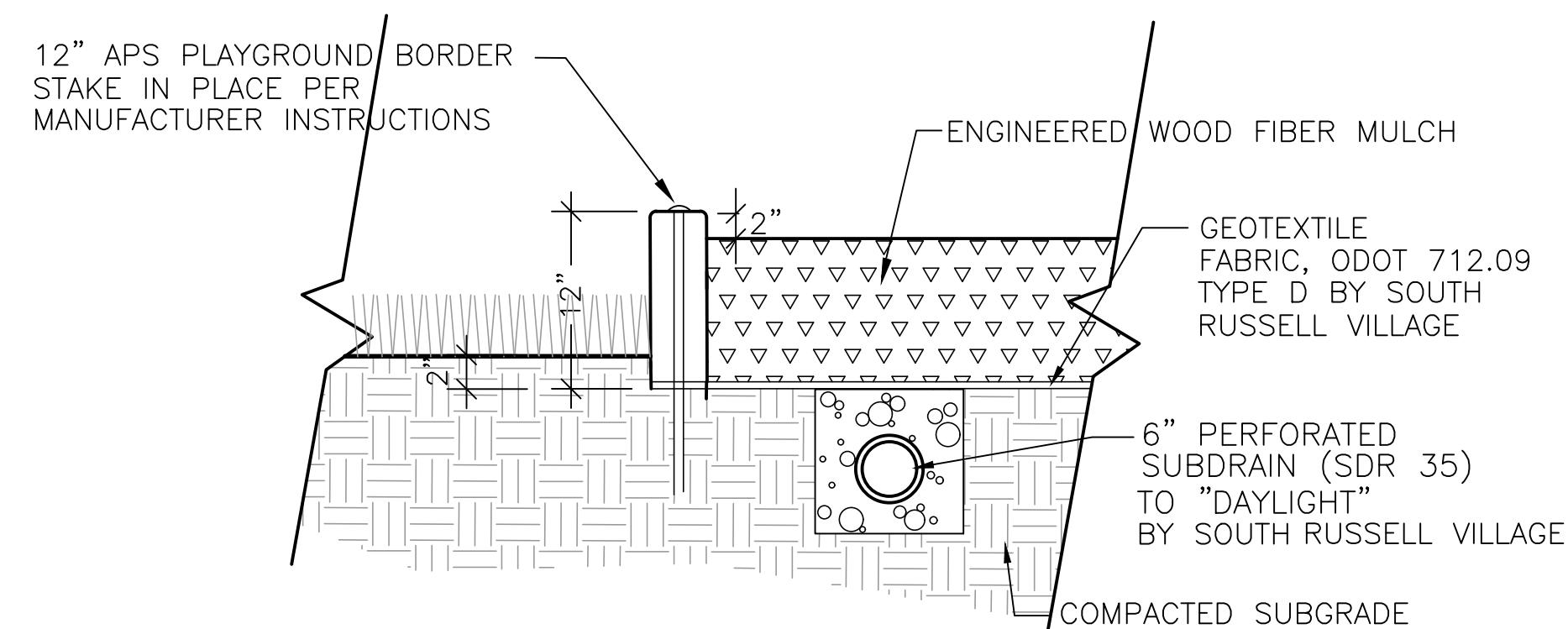
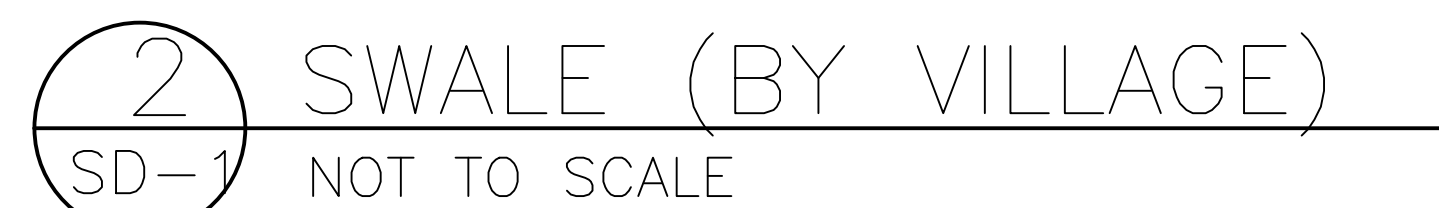
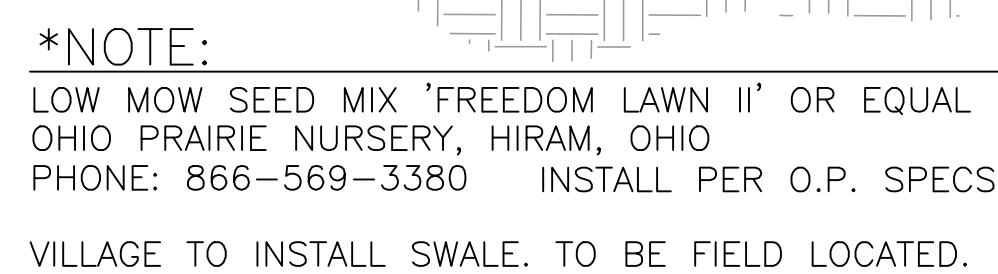

TRAIL

BELL ROAD

EXISTING LIMESTONE PATH

EXISTING GRAVEL PARKING LOT

FINELY CRUSHED COMPACTED LIMESTONE PATH

POTENTIAL FUTURE PARKING

EXISTING PICNIC SHELTER

ALT. FRENCH DRAIN

SWALE

BRIDGE OVER SWALE

DRAINAGE

PERFORATED PIPE (SDR 35)

60'

90°

60'

90°

80'-5"

85'-4"

1108

1110

1112

3 SD-1

1 SD-1

2 SD-1

4 SD-1

811

NORTH

SCALE: 1" = 10'

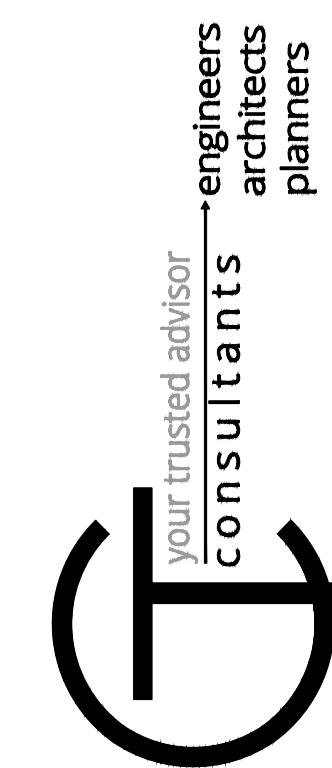
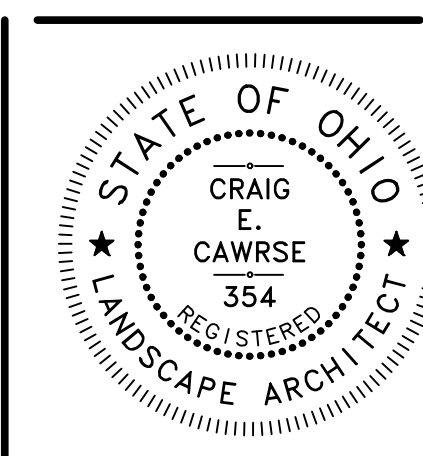

SITE LAYOUT/GRADING PLAN
SOUTH RUSSELL PLAYGROUND
PLAYGROUND PLAN

1000 BELL ST.
SOUTH RUSSELL, OHIO 44022

Date	Notes
12-11-17	DRWN RDS
12-13-17	DRWN RDS
12-20-17	DRWN RDS
01-25-18	DRWN RDS
04-25-18	DRWN RDS
05-01-18	DRWN RDS
05-21-18	DRWN RDS
05-22-18	DRWN RDS
07-02-18	DRWN RDS
01-08-19	DRWN RDS

Job No: 189993
File: South Russell Playground 2.dwg

SD-1

Sheet 1 of 4

C:\CT\CAD\AutoCAD\Temp\AutoCAD\1458\South Russell Playground.dwg

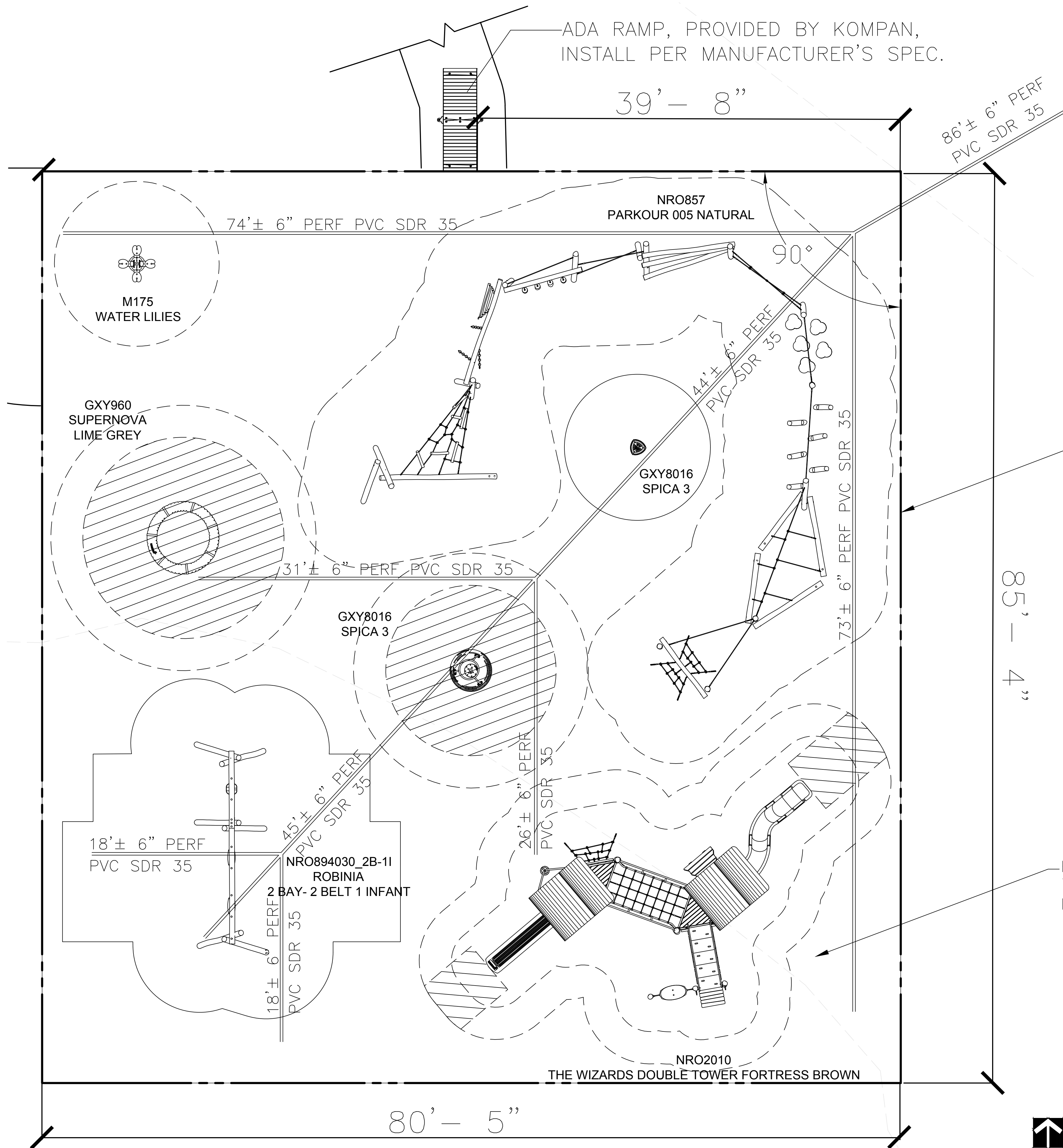

***NOTE:**

PLAYGROUND EQUIPMENT SHALL BE PROVIDED BY KOMPAN THROUGH AMERICAN ATHLETIX (888) 399-4999. INSTALL PER MANUFACTURER'S SPECIFICATIONS

CONTRACTOR WILL LAYOUT PLAY STRUCTURE LOCATIONS PRIOR TO INSTALLATION OF 6" PERF. PIPE INSTALLED BY SOUTH RUSSELL PROJECT LANDSCAPE ARCHITECT WILL APPROVE LAYOUT.

ADA RAMP SHALL BE FIELD LOCATED IN THE CENTER OF THE FINELY CRUSHED COMPACTED LIMESTONE PATH

12" APS PLAYGROUND BORDER PROVIDED BY KOMPAN ON ALL FOUR SIDES. INSTALL PER MANUFACTURER'S SPECIFICATIONS

ENGINEERED WOOD FIBER MULCH SPREAD THROUGHOUT THE PLAY AREA PROVIDED BY KOMPAN. INSTALL PER MANUFACTURER'S SPECIFICATIONS

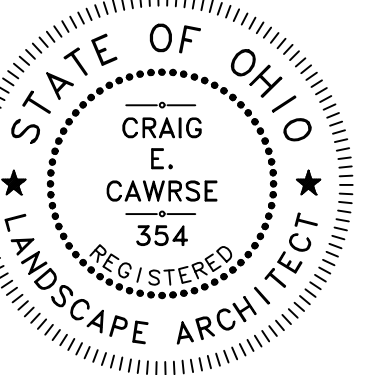
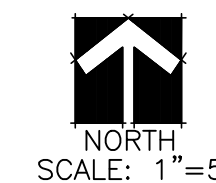

PLAYGROUND LAYOUT
SOUTH RUSSELL PLAYGROUND
PLAYGROUND PLAN

1000 BELL ST.
SOUTH RUSSELL, OHIO 44022

Date	Notes	
05-23-18	DRWN	RDS
07-02-18	DRWN	RDS
01-08-19	DRWN	RDS

Job No: 189993

File: South Russell Playground 2.dwg



SD-2

Sheet 2 of 4

PLANT MATERIAL LIST

QTY.	KEY	BOTANICAL NAME	COMMON NAME	SIZE	NOTES
6	AC-RS	ACER RUBRUM 'RED SUNSET'	RED SUNSET MAPLE	2-1/2" CAL.	B&B
4	QU-P	QUERCUS PALUSTRIS	PIN OAK	2-1/2" CAL.	B&B
5	UL-A	ULMUS AMERICANA 'PRINCETON'	PRINCETON AMERICAN ELM	2-1/2" CAL.	B&B

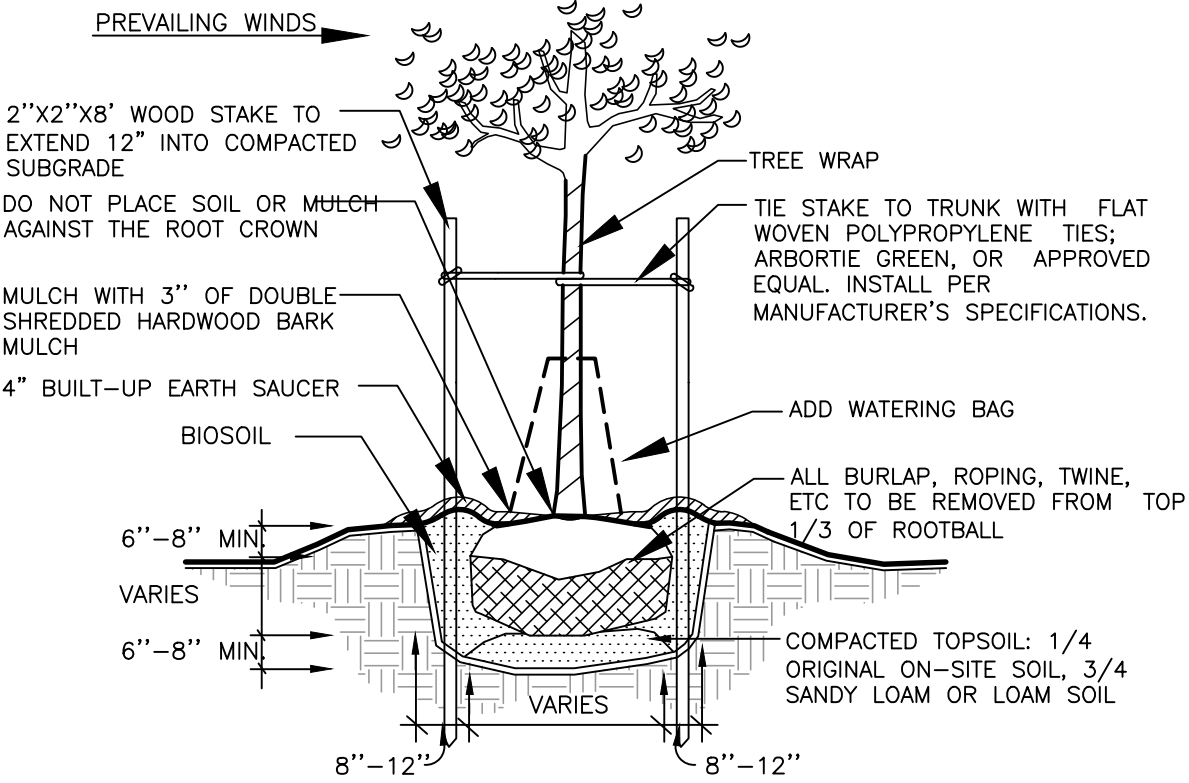

NOTE: ADD 'TERRA-SORB AG' OR EQUAL TO TOPSOIL AS PER MANUFACTURER'S RECOMMENDATIONS IF NO IRRIGATION IS APPLIED.

1 DECIDUOUS TREE PLANTING (BY OTHERS)
L-1 NOT TO SCALE

GENERAL PLANTING SPECIFICATIONS

- These documents are meant to serve as a guide for construction; modifications to the designs may be required to accommodate varying field conditions or modified plant arrangements.
- Quality and sizes of plants to meet American Association of Nurseryman Standards.
- Landscape Architect to be authority for interpretation of plan and quality of work.
- All substitutions of sizes or varieties subject to approval of Landscape Architect.
- If quantities listed in Plant Material List do not correlate with plantings indicated on plan, the quantities indicated on the plan shall govern.
- Contract shall consist of total units authorized by Owner.
- The Landscape Contractor to locate all underground utilities and/or sprinkler systems before installation.
- The Landscape Contractor is responsible for all clean-up associated with his construction procedure.
- All disturbed areas to receive a minimum 2" topsoil; rock free.
- Use soil mixture in all planting pits. Soil mixture to be 1/4 original on-site soil and 3/4 sandy loam or loam soil as defined by USDA Soil Conservation Service, Soil Classification System. Free from admixture of subsoil, heavy clay, coarse sand, stones, plants, roots, sticks, and any other foreign materials. 95% of topsoil shall pass a 2.0 mil sieve. Organic content shall be 4% to 12% of total dry weight. Add granular 'Soil Moist', 'Terra-Sorb', or equal to topsoil mix, applied per manufacturer's recommended rates for the size and type of plant material specified, if no irrigation is applied.
 - If the quality or quantity of on-site topsoil stockpiled is insufficient to complete work, provide imported topsoil. Obtain rights and pay all costs for imported topsoil material.
 - Proposed topsoil shall be acceptable to Architect and Soils Testing Firm.
- All nylon roping, twine, shall be removed, prior to planting. All non-treated burlap and/or non-rot proof burlap to be removed from top half of rootball. All treated burlap or polypropylene burlap to be completely removed from planting pit.
 - Fertilizer: Each tree planting to receive Granular Nitroform (18-6-12) fertilizer or equal. Deliver fertilizer to the site in bags or other convenient containers, each fully labeled, conforming to the applicable State Fertilizer Law, and bearing the name, trade name or trademark, and warranty of the producer.
- Seeding Mixture: Seed shall be low mow mix "Freedom Lawn II" or approved equal. Fertilize with a non-burning measured release fertilizer, or rake in a light application of 12-12-12 at a rate of 15 lb. per 1,000 S.F. before seeding.
- All areas to be seeded are to be free from weeds and rocks 3/4" or larger. All seeded areas are to be covered with a 1 1-1/2" thick non-compacted layer of straw.
- Reseed all disturbed areas with appropriate seed mix.
- All plant materials to be inspected and approved by Landscape Architect before final acceptance of work, by the owner.
- All landscaping material shall be guaranteed for a period of one (1) year from the date of acceptance of the work, by the owner.

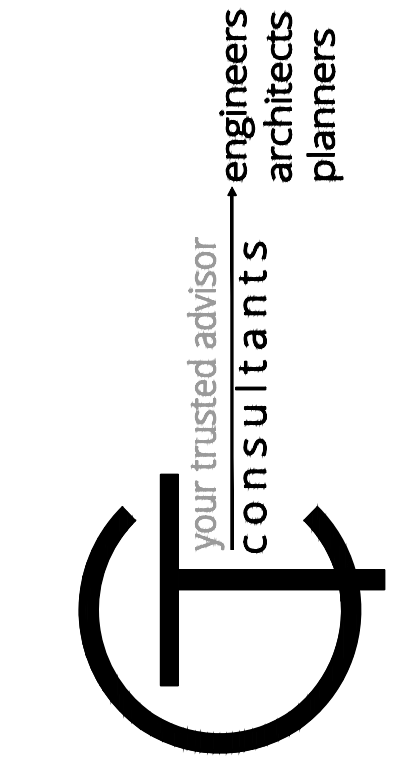
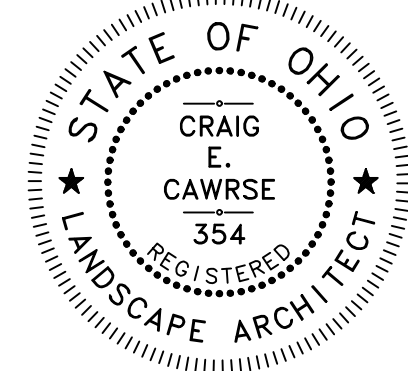
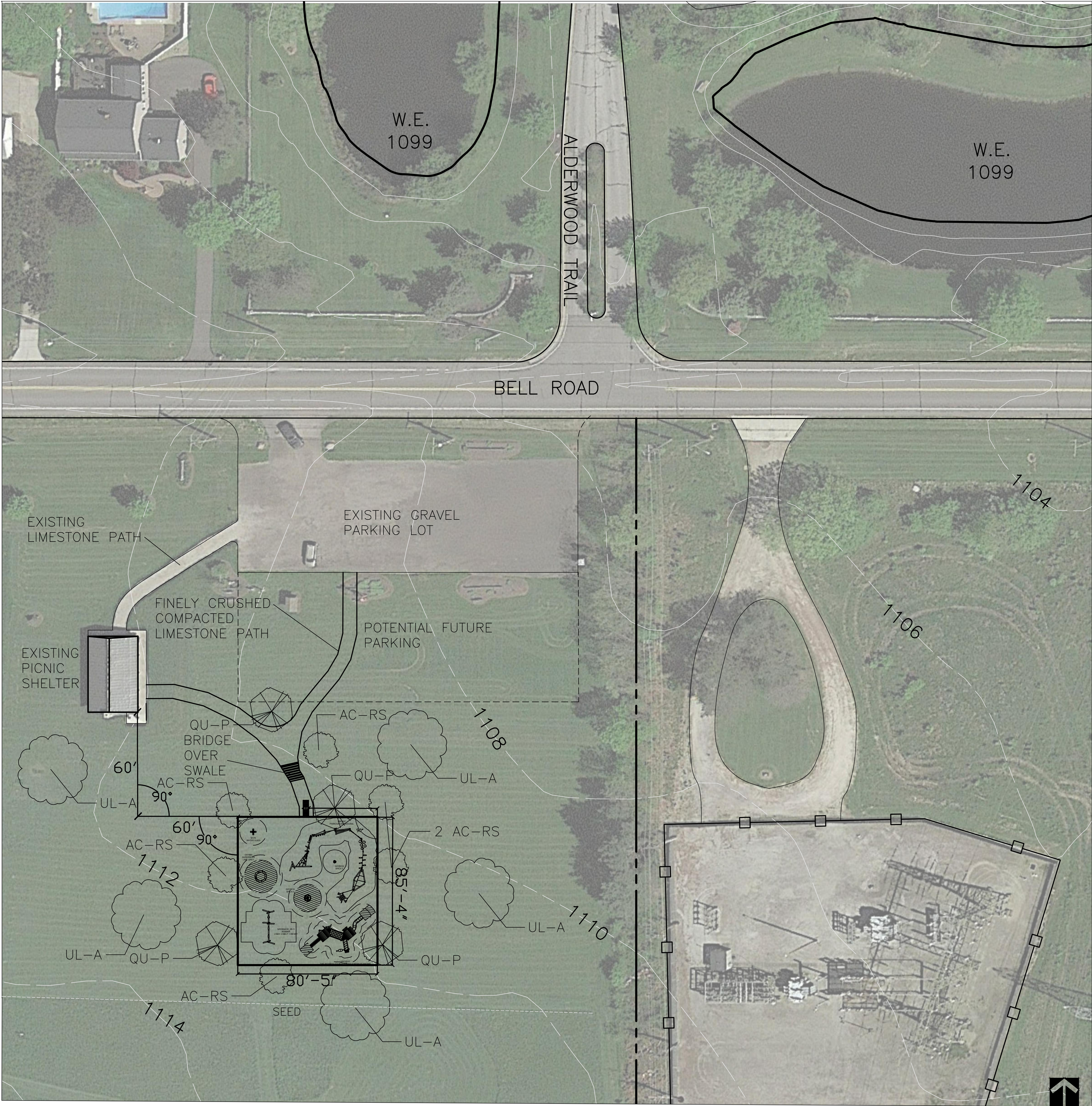

SITE LANDSCAPE PLAN
SOUTH RUSSELL PLAYGROUND
PLAYGROUND PLAN
1000 BELL ST.
SOUTH RUSSELL, OHIO 44022

Date	Notes	
05-21-18	DRWN	RDS
06-26-18	DRWN	RDS
07-02-18	DRWN	RDS
01-08-19	DRWN	RDS

Job No: 189993
File: South Russell Playground 2.d



Know what's below.
Call before you dig.

Non-Sediment
Pollution Controls

1. No solid or liquid waste, including building materials or their packaging, shall be discharged in storm water runoff.
2. Concrete trucks are not permitted to wash directly into storm sewers, streams or drainage channels.
3. Off-site tracking of sediment by construction vehicles must be minimized.
4. Waste disposal via open burning is prohibited where not permitted under the State of Ohio open burning laws.
5. Contaminated soils or soils where construction site chemicals or petroleum products have been spilled must be treated and/or disposed of at an Ohio EPA-approved solid waste management facility or a hazardous waste treatment, storage or disposal facility (TSDF).
6. Storm water that comes in contact with contaminated soils or solid and industrial waste must be collected and disposed of as a wastewater.
7. Fuel tanks and drums or other containers holding construction site chemicals must be stored within a diked area.
8. Sediment-laden trench or ground water must pass through a sediment-settling pond or be dewatered in place using a sump pit, filter bag or other comparable method prior to being discharged from the site.
9. Trench and ground water free from sediment or other pollutants may be discharged without treatment provided this water does not become pollutant-laden by traversing over disturbed soils or other pollutant sources.
10. No toxic or hazardous wastes shall be disposed into storm drains, septic tanks or by burying, burning or mixing the wastes.
11. Provide covered and leak-proof containers to store debris, trash, and hazardous or petroleum wastes for proper disposal.
12. All construction and demolition debris waste must be disposed of in an Ohio EPA approved C&DD landfill as required by Ohio Revised Code 3714.
13. A spill-prevention and countermeasures (SPCC) plan must be developed for sites with one above-ground storage tank of 660 gallons or more, total above-ground storage of 1,330 gallons, or below-ground storage of 42,000 gallons of fuel.
14. Process wastewaters (equipment washing, leachate and concrete wash-outs) must be collected and disposed of at a publicly-owned treatment works.
15. Use protected storage areas for industrial and construction materials to minimize exposure of such materials to storm water.
16. Petroleum waste spills of 25 gallons or more require notification of Ohio EPA (800-282-9378), local fire department (and if applicable) the local emergency planning committee within 30 minutes. For smaller spills of petroleum-based or concrete curing compounds, consult manufacturers' special handling procedures.

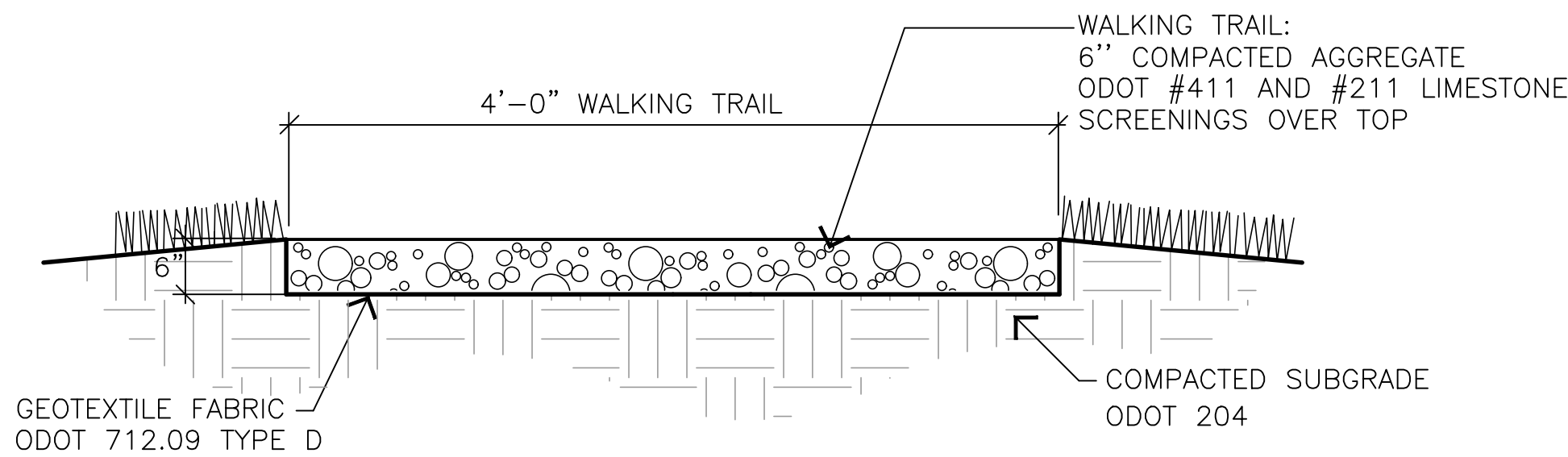

1 LIMESTONE PATH (BY VILLAGE)
SWPP-1 NOT TO SCALE

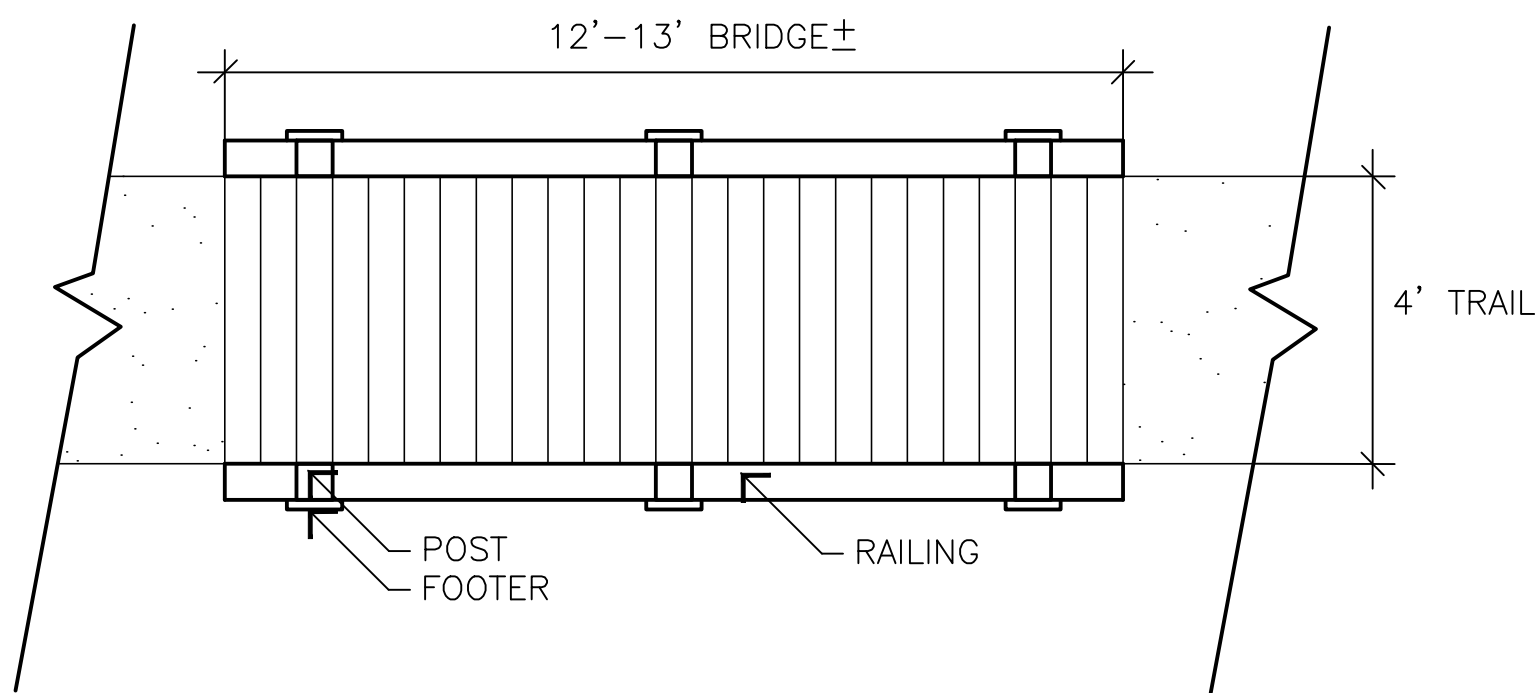

*NOTE:
1. BRIDGE TO BE COMPLETED BY OTHERS
2. MATERIAL TO BE TREX OR TREATED LUMBER FOR DECKING

2 BRIDGE (BY OTHERS)
SWPP-1 NOT TO SCALE

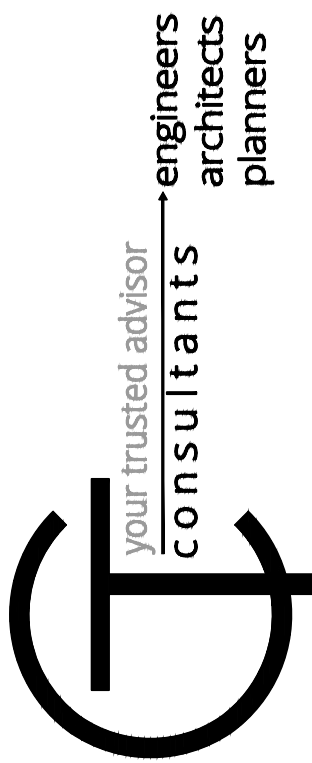
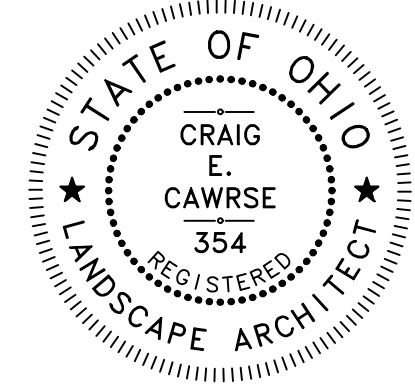
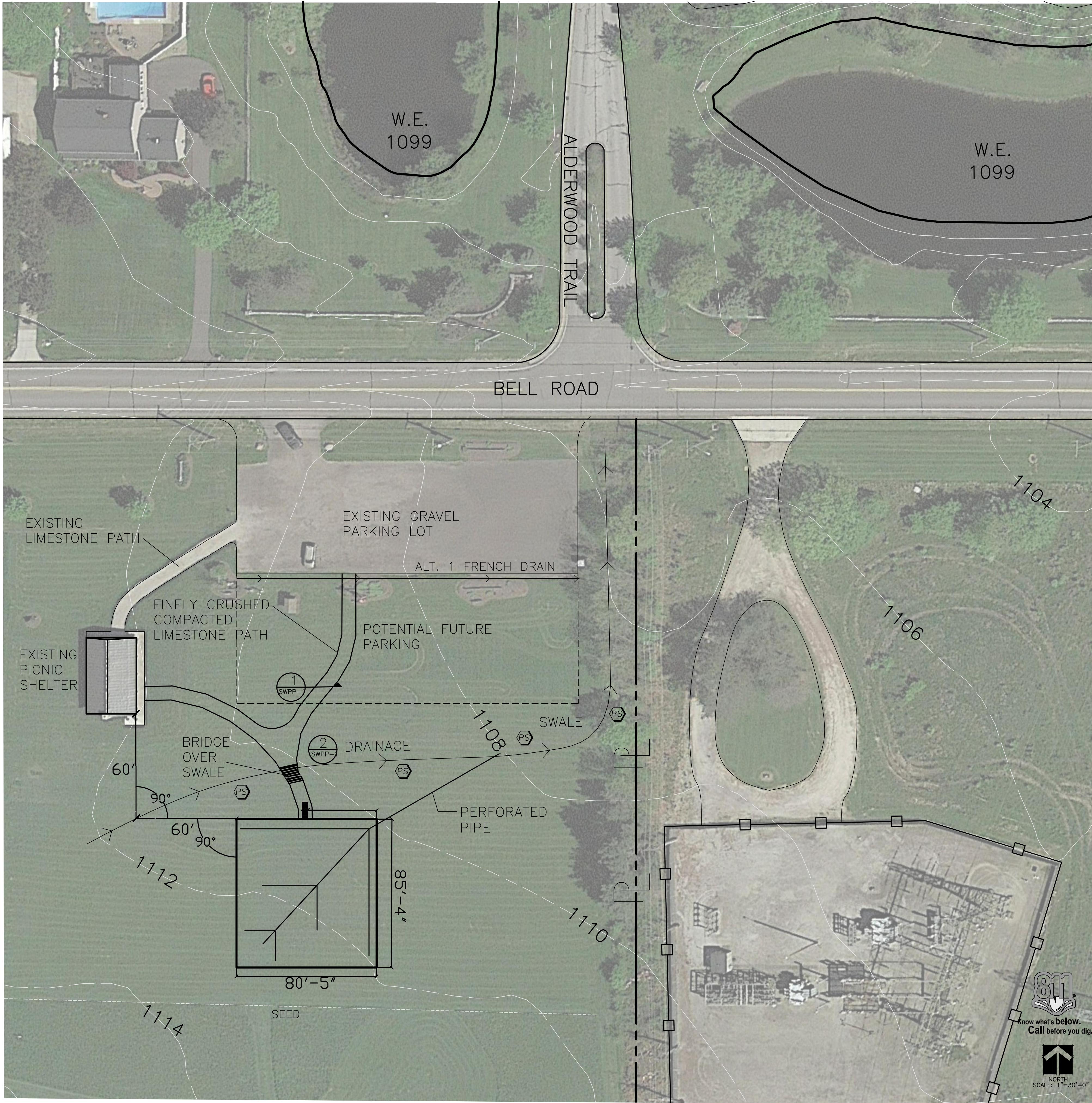

STORMWATER POLLUTION PREVENTION PLAN
SOUTH RUSSELL PLAYGROUND
PLAYGROUND PLAN
1000 BELL ST.
SOUTH RUSSELL, OHIO 44022

Date	Notes	
06-27-18	DRWN	RDS
07-02-18	DRWN	RDS
01-08-19	DRWN	RDS

Job No: 189993
File: South Russell Playground 2.dwg

SWPP-1