

*Never
5-5-18*



South Russell Park

Playground Proposal



5630 Spring River Avenue
Dublin, OH 43018

Eric Jones
eric@americanathletix.com
Ohio Recreation Consultant

call (614) 527-7238
fax (888) 295-2319

www.americanathletix.com/kompan



EVERYWHERE PEOPLE PLAY

Bleachers • Stadium Seating • Playgrounds
Scoreboards • Gymnasium Equipment
Shelters • Site Amenities • More

Info@americanathletic.com • Office: (888) 399-4999 • Fax: (888) 295-2319 • P.O. Box 1881 • Muskegon, MI 494

South Russell Park
Attn: Ike Tripp
South Russell Village
5205 Chillicothe Rd
South Russell, Ohio 44022

Parkour 5, Wizard Double Tower

Quotation
Date: 4.18.18
Quote #: SRP04018-1
Expires: 07.01.18
Approx. Lead Time 10 weeks

Description: US Communities Contract Pricing

quantity	item number	description	Each	net
✓ 1	NRO857-1013	PARKOUR 005 US BROWN	\$ 18,680.00	\$ 16,812.00
✓ 1	NRO2010-1011	THE WIZARD'S DOUBLE TOWER FORTRESS BROWN	\$ 46,840.00	\$ 42,156.00
✓ 1	ELE400065-3717GR	TIP1 CAROUSEL WITH TOP BRACE GREEN - INGROUND	\$ 4,210.00	\$ 3,789.00
✓ 1	GXY960012-3417	SUPERNOVA - GREY/LIME GREEN (ASTM)	\$ 8,170.00	\$ 7,353.00
✓ 1	M17501-12P	WATER LILIES SPRINGER INGR 60 CM	\$ 1,110.00	\$ 999.00
✓ 1	ROBINIA SWING	2 BAY SWING, (1) TOT SWING, (2) STANDARD SWING	\$ 5,380.00	\$ 4,842.00
✓ 1	GXY801621-3717	SPICA 3 009/03 90 CM IN-GROUND ANCHOR.	\$ 2,040.00	\$ 1,836.00
✓ 1	INSTALL	PROFESSIONAL INSTALLATION	\$	\$ 21,100.00
✓ 82	BORDERS	4 X 12" BORDERS, BLACK	\$ 27.50	\$ 2,255.00
✓ 1	ADA	FULL ADA RAMP	\$	\$ 657.00
✓ 4	R20C4836	DYNACUSHION WEAR MATS 4'X3'X2"	\$ 127.00	\$ 508.00
✓ 1	EWFF	ENGINEERED WOOD FIBER	\$	\$ 7,705.00

Sub-Total: \$ 110,012.00
 Freight*: \$ 3,585.00
 Tax: NA
 Engineering: NA
 Quote Total: \$ 113,597.00

*ACCEPTANCE OF QUOTATION: This quotation is subject to policies in the current catalog and the following terms and conditions.

Quotation is based on shipment of all items at the same time to one destination, unless otherwise noted. Pricing is subject to change beyond expiration date.

Purchases in excess of \$1,000 must be supported by a written Purchase Order to: American Athletic, LLC

LEAD TIME: Final dates from receipt of deposit (if required); final approved drawings; colors and site prep and readiness.

WEIGHT: Freight charges are estimated. Subject to final charges from freight carrier.

EXCLUSIONS: Unless specifically included, this quotation excludes: all site work and landscaping; removal and disposal of existing equipment;

acceptance of equipment and off-loading; storage of goods prior to installation; equipment assembly and installation; safety surfacing; borders and drainage provisions.

Proposal by: Eric W Jones, American Athletic, LLC

Eric@americanathletic.com

Accepted by: _____ Date: _____

Purchase Order: _____

Visit our website at: www.americanathletic.com

Thank you for the opportunity!

We Proudly Partner with:





Best User Age: 5-12 years

Footings: In-ground installation only

Technical information available at koman.com

ADA ANALYSIS	Elevated Activities	Ground Level Activities	Ground Level Play Types
Present	0	10	2
Accessible	0	10	2
Required	0	2	2

ROBINIA

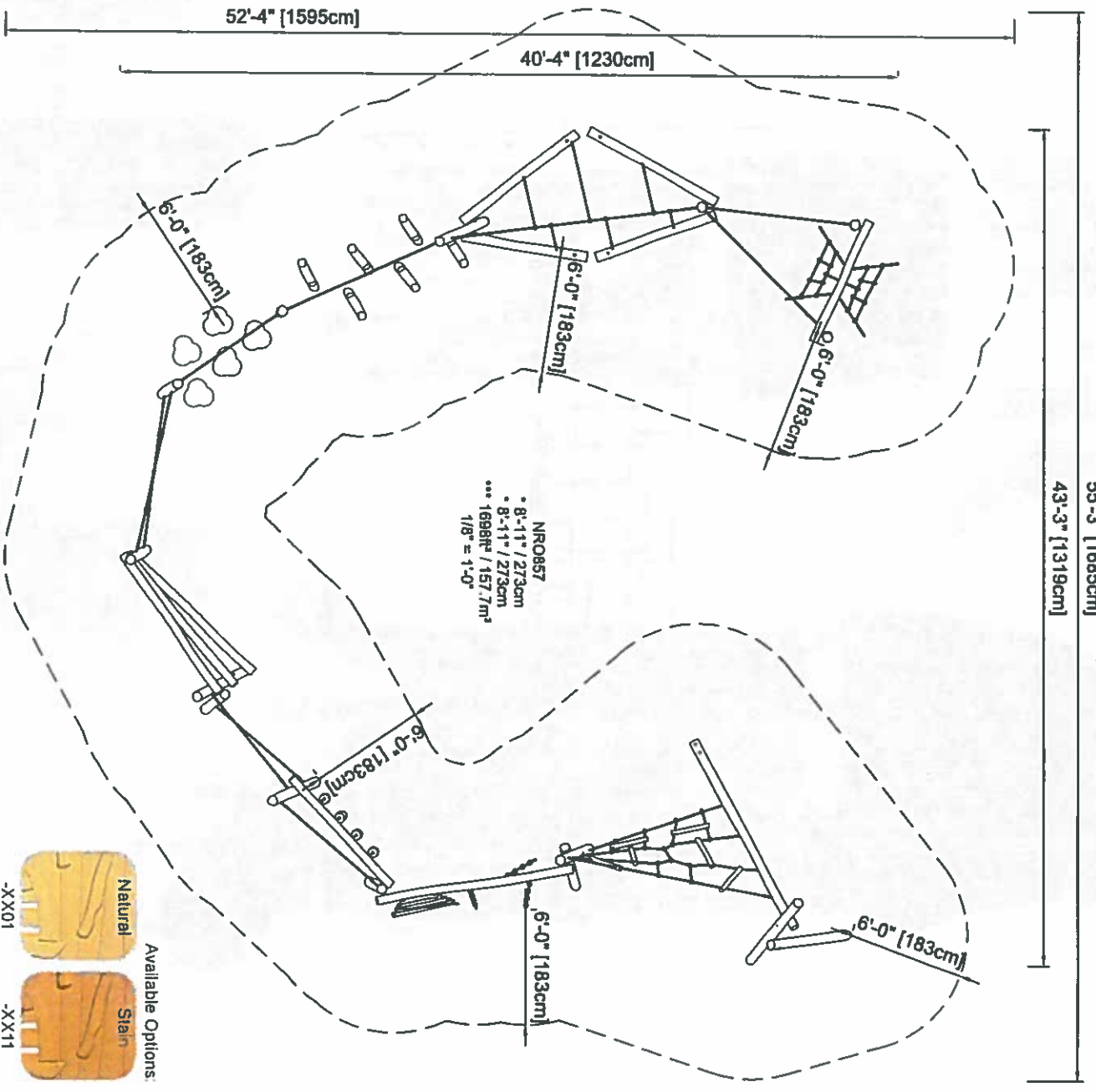

• = Highest designated play surface
 ** = Total height of product
 *** = Total area of safety zone
 Highest designated play surface space required and total area of safety zone are according to ASTM F1487. Equipment must be installed over resilient surfacing appropriate to the safety guidelines in your area.

Product development is an ongoing process. We reserve the right to make modifications on all our products. This product may not be mirrored, scaled or altered in any way. Safety zones must be retained for proper placement of equipment. If any changes are required, please contact your KOMPAN representative at 1.800.426.9788.



To verify product certification, visit www.ipema.org

KOMPAN Product Info

THE WIZARD'S DOUBLE TOWER FORTRESS

- NRO2010



Best User Age: 5-12 years

Footings: In-ground installation only

Technical information available at koman.com

ADA ANALYSIS	Elevated Activities	Ground Level Activities	Ground Level Play Types
Present	8	2	2
Accessible	5	2	2
Required	4	3	3

ROBINIA

Available Options:

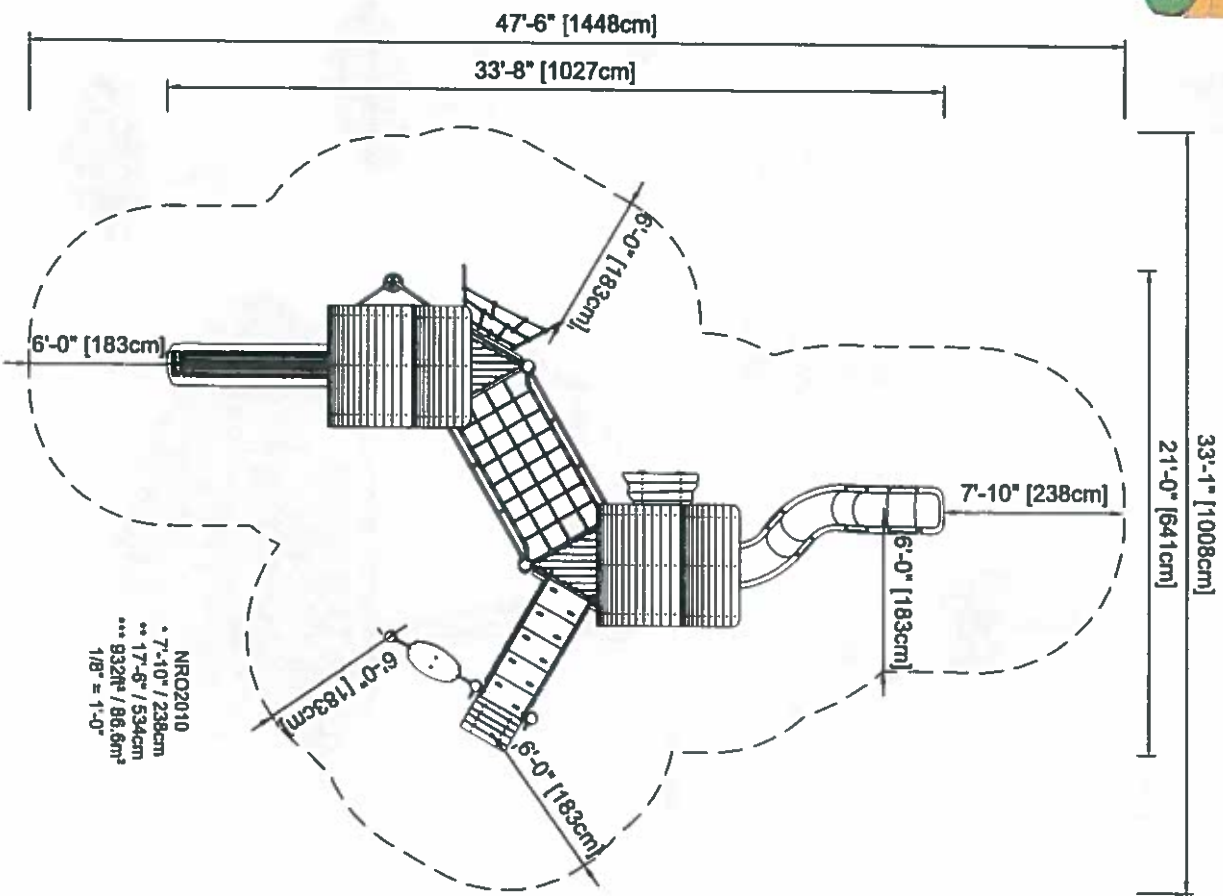

* = Highest designated play surface

** = Total height of product.

*** = Total area of safety zone.

Highest designated play surface, space required and total area of safety zone are according to ASTM F1487. Equipment must be installed over resilient surfacing appropriate to the safety guidelines in your area.

Product development is an ongoing process. We reserve the right to make modifications on all our products. This product may not be mirrored, scaled or altered in any way. Safety zones must be retained for proper placement of equipment. If any changes are required, please contact your KOMPAN representative at 1.800.426.9788.



To verify product certification, visit www.ipema.org

GXY916012

Supernova - Gray



Supernova You-Tube Video

Product line	Traditional Play
Product category	Supernova, carousels & spinners
Best user age	5 - 12
Max. fall height (Feet)	100
Total height (Feet)	60
Safety zone area	289 m2



ASTM

SPINNING GATHERING BALANCING



Best User Age: 2-5 years

Footings: In-ground posts

Surface Installation also available

Technical Information available at koman.com

ADA ANALYSIS

Elevated Activities 0	Accessible Elevated Activities	Accessible Ground Level Activities	Accessible Ground Level Play Types
Present	0	1	1
Required	0	1	1

MOMENTS

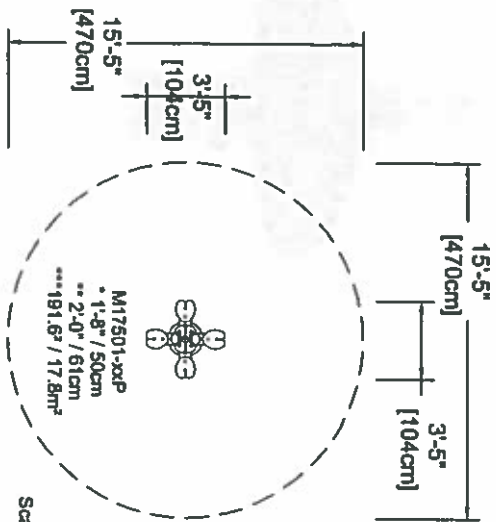
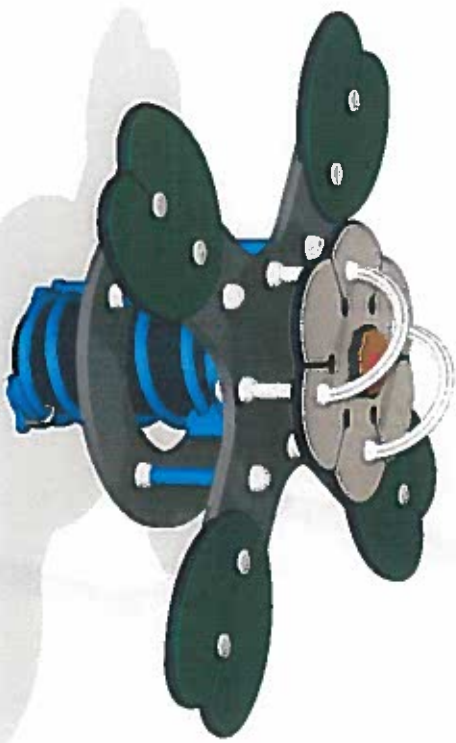

Scale: 1/8" = 1'-0"

* = Highest designated play surface.

** = Total height of product.

Highest designated play surface and space required are according to ASTM F1487

Equipment must be installed over resilient surfacing appropriate to the safety guidelines in your area.

Product development is an ongoing process. We reserve the right to make modifications on all our products. This product may not be mirrored, scaled or altered in any way. Safety zones must be retained for proper placement of equipment. If any changes are required, please contact your KOMPAN representative at 1.800.426.9788.



To verify product certification, visit www.ipedma.org

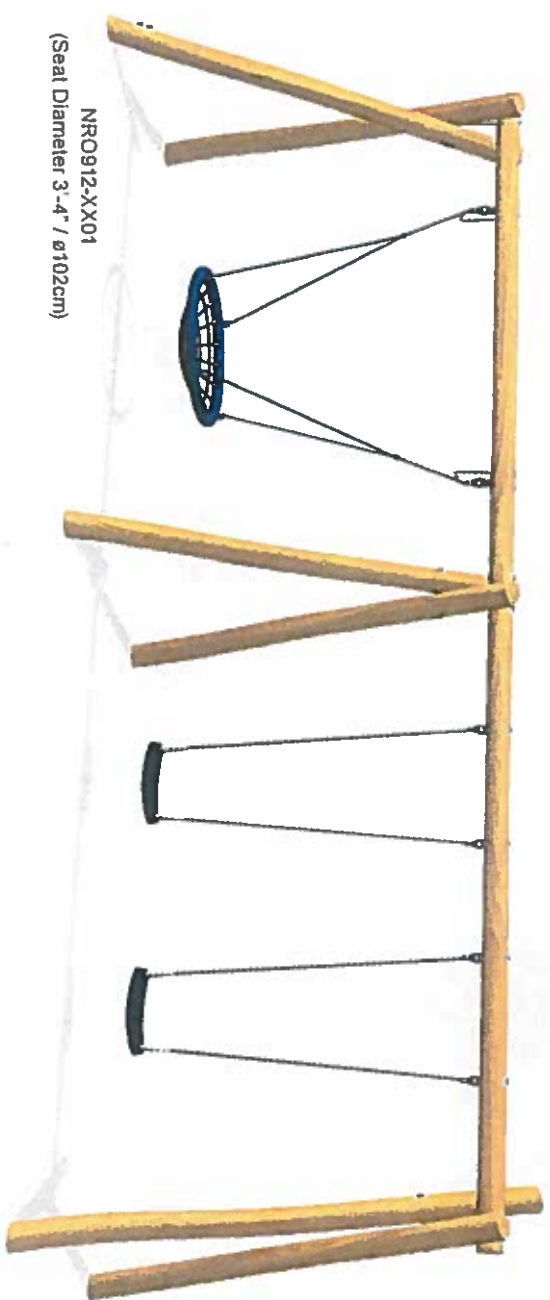

NR0912-XX01
(Seat Diameter 3'-4" / ø102cm)

infant seat instead of basket swing

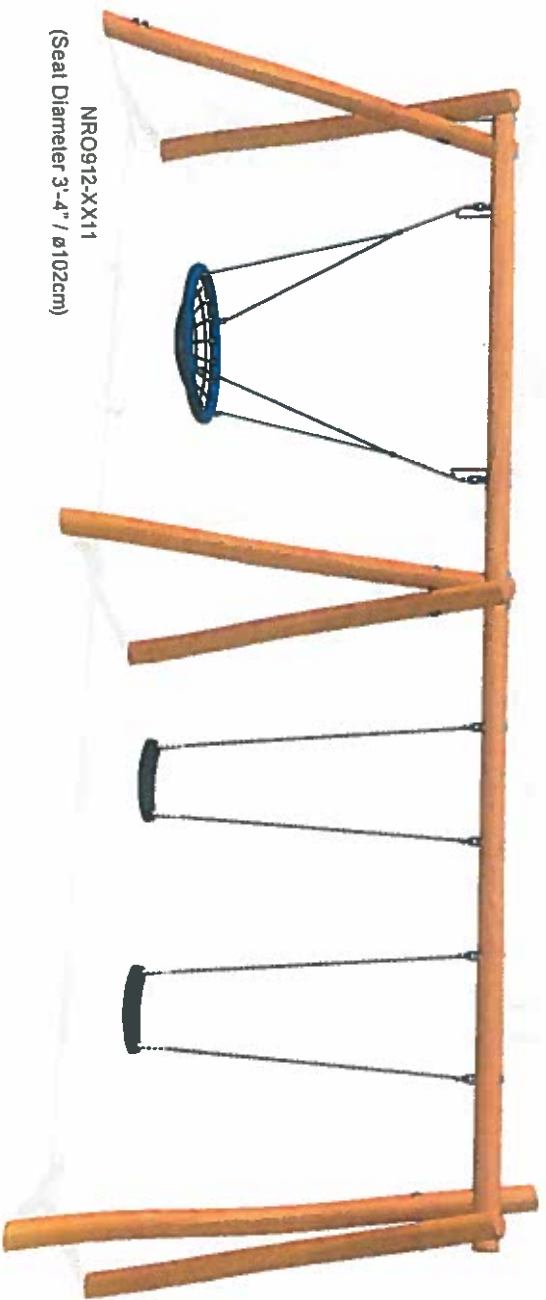

NR0912-XX11
(Seat Diameter 3'-4" / ø102cm)

Playground Borders

Action Play Systems offers the highest quality playground border in the industry. APS playground borders are 4' 4" long, 4" wide and available in either 8" or 12" heights.

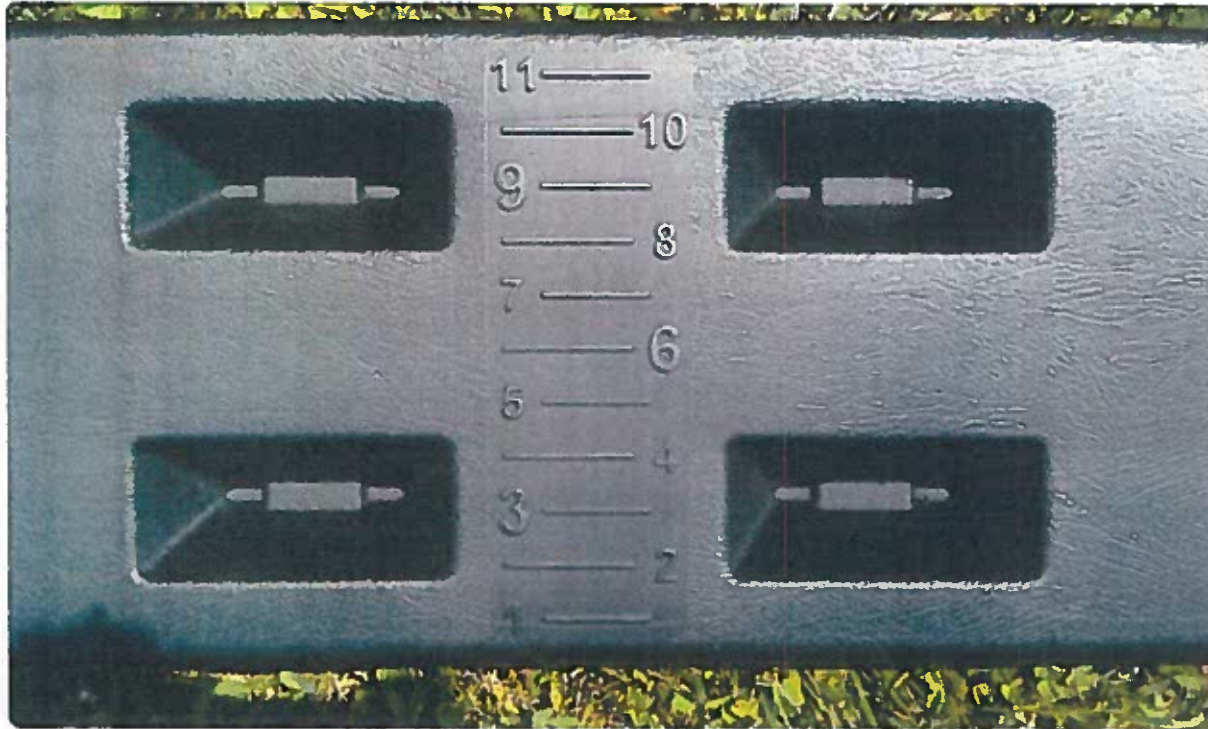

APS Surfacing Guide (US Patent #D716,113)



DYNACUSHION™ WEAR MATS

The patented DynaCushion Wear-Mat™ is constructed of 100% recycled tire rubber, and is designed to eliminate erosion around playground equipment and kick out areas at all play structure exits. The DynaCushion has excellent shock absorbency characteristics with a certified 6 ft. fall height, therefore making it the best value in the industry.

SPECIFICATIONS

- R20C4872 - 4'x6'x2" - 192 lbs.
- R20C4848 - 4'x4'x2" - 128 lbs.
- R20C4836 - 4'x3'x2" - 96 lbs.
- R20C4824 - 4'x2'x2" - 64 lbs.
- R13C4872 - 4'x8'x1-1/4" - 144 lbs.
- R13C4848 - 4'x4'x1-1/4" - 96 lbs.
- R13C4836 - 4'x3'x1-1/4" - 72 lbs.
- R13C4824 - 4'x2'x1-1/4" - 48 lbs.

The DynaCushion provides you with durability, performance, and guaranteed impact attenuation.

PERFORMANCE WARRANTY

DynaCushion Wear Mat is guaranteed to be in compliance with ASTM F1292-84 and F1951, designed to provide a new level of confidence and protection.

PRODUCT WARRANTY

DynaCushion Wear Mats carry a 5 year limited product warranty against defective materials and manufacturer workmanship of the product.

DURABLE

No other wear mat can match the innovative design of the DynaCushion Wear Mat, stability, longevity, durability, and resistance to wear.

CERTIFICATION

DynaCushion Wear Mat is certified to meet ASTM requirements for impact attenuation.

**Fall Protection
Up to 6'**

Physical Properties

Test Description	Test Ref.	Results
Wear Resistant	ASTM D3884	Passed
Slip Resistant	ASTM F-1677	Passed
Non Flammable	ASTM 2858	Passed
Non Toxic	ASTM 2075	Lead: Not Detected

You Know the Problem...



Meet the Solution



DynaCushion™ Wear Mats



The ideal wear mat for swing sets, slides, and other high-traffic locations. Easy to install, mats to place on playgrounds and under rubber slides, or concrete pads.

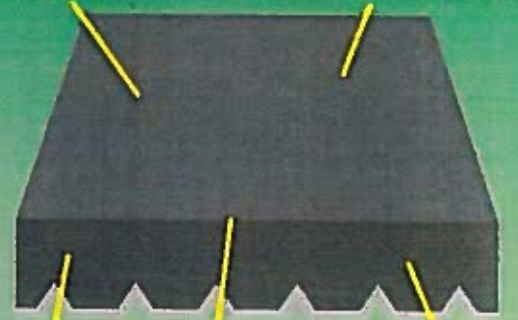

Meets ASTM (CPSC) and (ADA) requirements. Maximum versatility. Use with loose fill systems or use alone to cover hard surfaces. Features corrugated under-surface to provide shock absorbency.

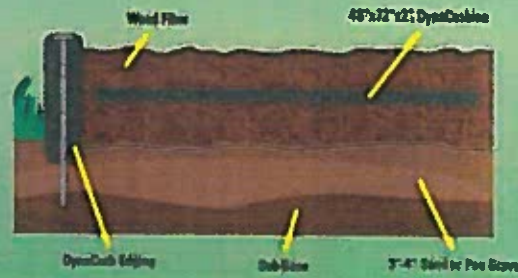

Weld Fibers, 48"x72"x2" DynaCushion, DynaCushion Edging, Sub-base, 3"-4" Sand or Pea Gravel.



Bleachers + Stadium Seating + Playgrounds
Scoreboards + Gymnasium Equipment
Shelters + Site Amenities + More

Info@americanathletix.com Office: (888) 399-4999 Fax: (888) 295-2319 P.O. Box 1881 Muskegon, MI 49443

South Russell Park
Attn: Ike Tripp
South Russell Village
5205 Chillicothe Rd
South Russell, Ohio 44022

Parcour 4, Wizard Double Tower

Quotation
Date: 4.18.18
Quote #: SRP040418-2
Expires: 07.01.18
Approx. Lead Time 10 weeks

Description: US Communities Contract Pricing

quantity	Item number	description	Each	net
✓ 1	NR0854-1011	PARCOUR 004 BROWN	\$ 8,520.00	\$ 7,668.00
✓ 1	NR02010-1011	THE WIZARD'S DOUBLE TOWER FORTRESS BROWN	\$ 46,840.00	\$ 42,156.00
✓ 1	ELE400065-3717GR	TIP1 CAROUSEL WITH TOP BRACE GREEN - INGROUND	\$ 4,210.00	\$ 3,789.00
✓ 1	GXY960012-3417	SUPERNOVA - GREY/LIME GREEN (ASTM)	\$ 8,170.00	\$ 7,353.00
✓ 1	M17501-12P	WATER LILIES SPRINGER INGR 60 CM	\$ 1,110.00	\$ 999.00
✓ 1	ROBINIA SWING	2 BAY SWING, (1) TOT SWING, (2) STANDARD SWING	\$ 5,380.00	\$ 4,842.00
✓ 1	GR901621-3717	SPICA 3 009/03 90 CM IN-GROUND ANCHOR.	\$ 2,040.00	\$ 1,836.00
✓ 1	INSTALL	PROFESSIONAL INSTALLATION	\$	\$ 19,120.00
✓ 82	BORDERS	4 X 12" BORDERS, BLACK	\$ 27.50	\$ 2,255.00
✓ 1	ADA	FULL ADA RAMP	\$	\$ 657.00
✓ 4	R20CA836	DYNACUSHION WEAR MATS 4'X3'X2"	\$ 127.00	\$ 508.00
✓ 1	EWf	ENGINEERED WOOD FIBER	\$	\$ 7,705.00

Sub-Total: \$ 98,888.00
Freight*: \$ 3,400.00
Tax: NA
Engineering: NA
Quote Total: \$ 102,288.00

*ACCEPTANCE OF QUOTATION: This quotation is subject to policies in the current catalog and the following terms and conditions.

Quotation is based on shipment of all items at the same time to one destination, unless otherwise noted. Pricing is subject to change beyond expiration date.

Purchases in excess of \$1,000 must be supported by a written Purchase Order for American Athletic, LLC.

LEAD TIME: Tentative dates from receipt of deposit (if required); final approved drawings; colors and site prep and readiness.

REGION: Freight charges are estimated. Subject to final charges from freight carrier.

EXCLUSIONS: Unless specifically included, this quotation excludes: all site work and landscaping; removal and disposal of existing equipment; acceptance of equipment and off-loading; storage of goods prior to installation; equipment assembly and installation; safety surfacing; borders and drainage provisions.

Proposal by: Eric W Jones, American Athletic, LLC

Eric@americanathletix.com

Accepted by: _____ Date: _____

Purchase Order: _____

Visit our website at: www.americanathletix.com

Thank you for the opportunity!

We Proudly Partner with:



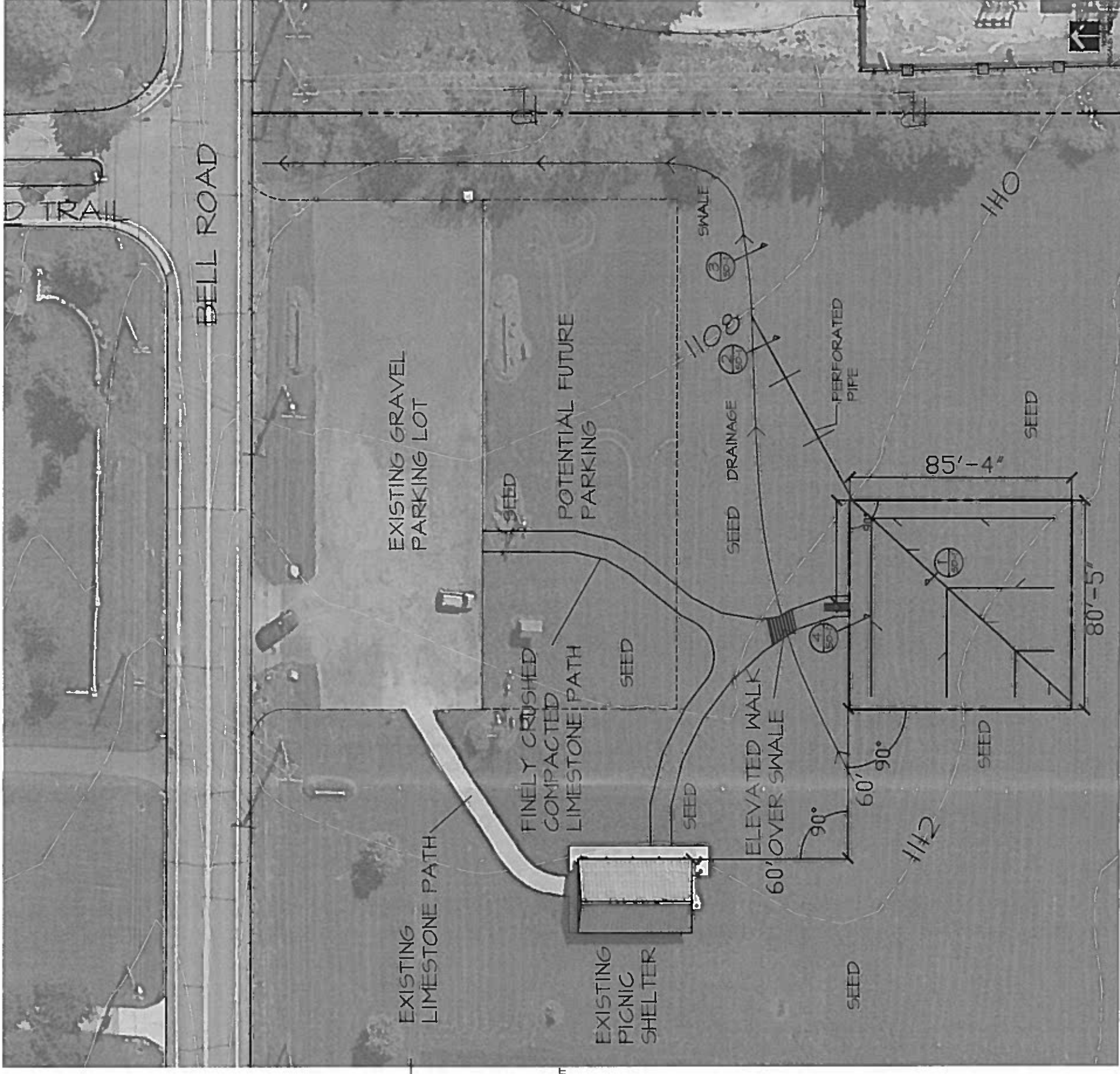
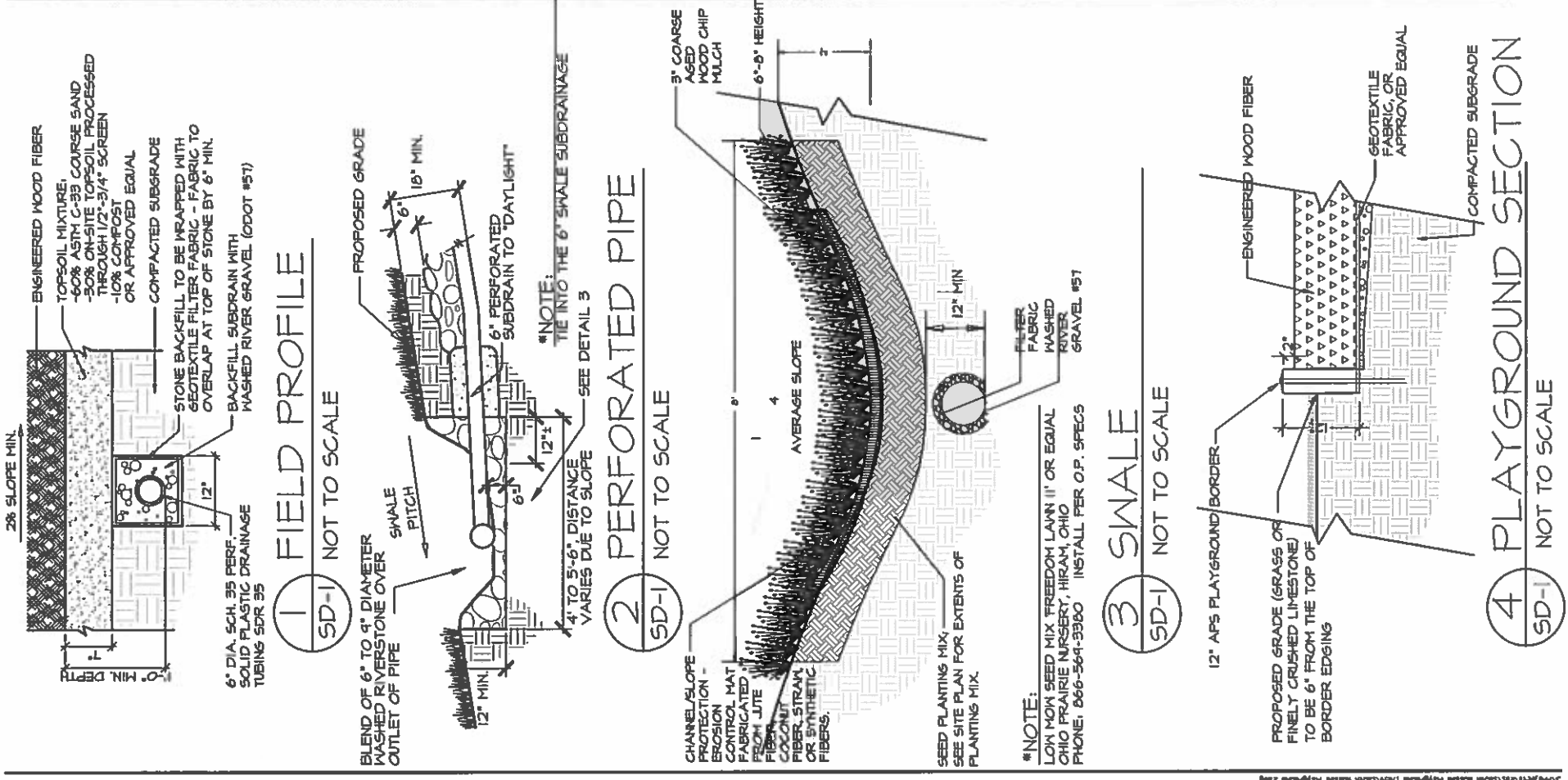

CAWRISI & ASSOCIATES, INC.
Landscape Architecture • Land Planning
549 E. Washington Street • Chagrin Falls, OH 44022
440 241-7003/fax 440 241-7143





CAVRSKI & ASSOCIATES, INC.
 Landscape Architecture • Land Planning
 519 R. Washington Street • Chagrin Falls, OH 44022
 440 241-7003/fax 440 241-7143



KOMPAN PLAYGROUND LAYOUT
 SOUTH RUSSELL PLAYGROUND
 PLAYGROUND PLAN
 1000 BELL ST.
 SOUTH RUSSELL, OHIO 44022

Date: Notes
 9-25-16 DRAW RDS
 9-21-16 DRAW RDS

Job: N013077
 File: South Russell Playground

SD-2

Sheet 2 of 4



*NOTE:
 KOMPAN INSTALLATION CONTRACTOR WILL LAYOUT PLAY STRUCTURE LOCATIONS PRIOR TO INSTALLATION OF EQUIPMENT. PROJECT LANDSCAPE ARCHITECT WILL APPROVE LAYOUT.
 ADA RAMP SHALL BE FIELD LOCATED IN THE CENTER OF THE FINELY CRUSHED COMPACTED LIMESTONE PATH

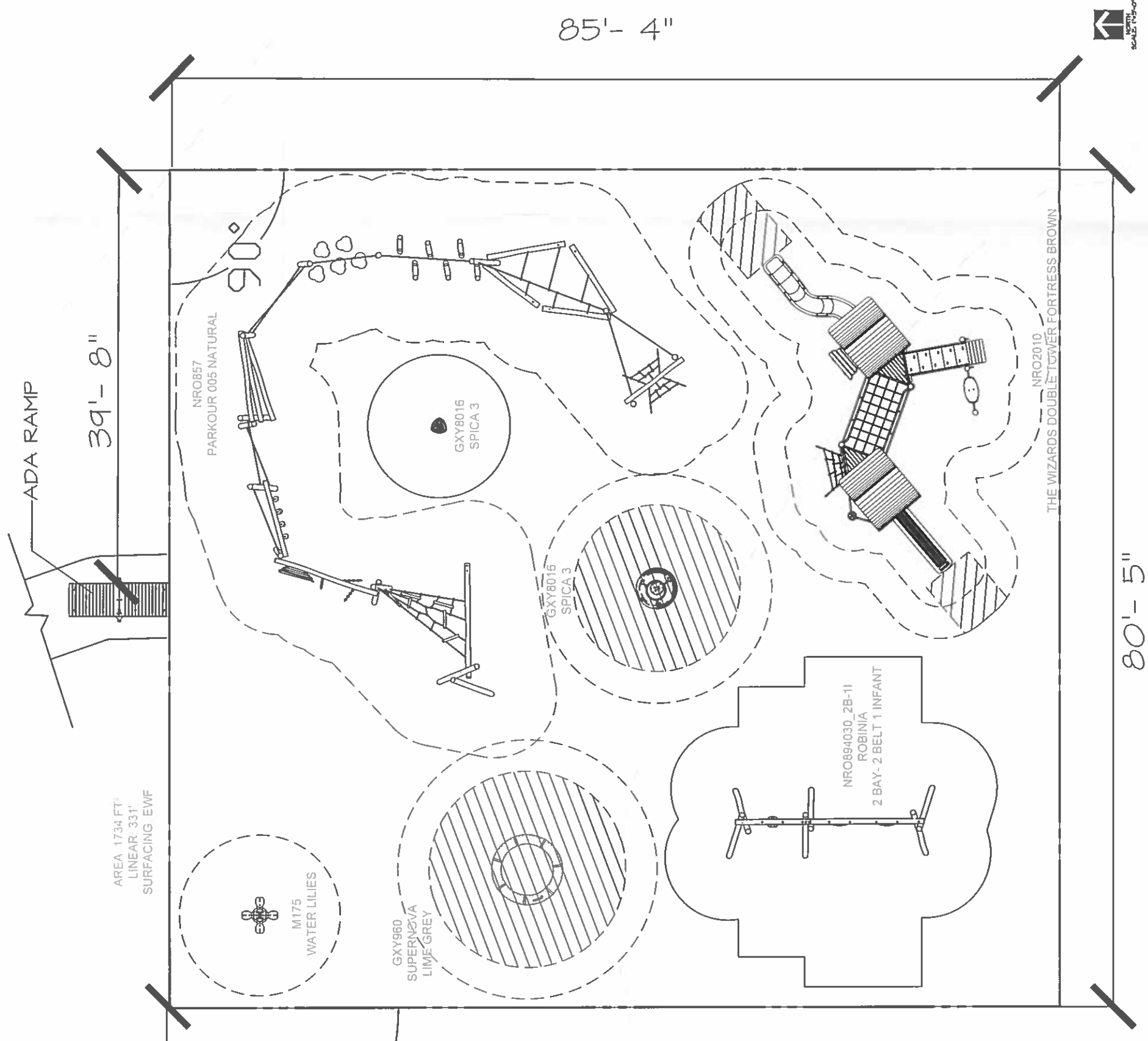

Project: 11/25/2016 South Russell Playground Based: Playground Based Playground Layout