

# Village of South Russell Zoning Map

- 1 ARROW WOOD CR. (PVT.)
- 2 BUTTON BRUSH CR. (PVT.)
- 3 TEABERRY CR. (PVT.)
- 4 WOODRUS CR. (PVT.)
- 5 BELLEFLOWER CR. (PVT.)
- 6 CHESTNUT N. (PVT.)
- 7 SORRELLWOOD LN. (PVT.)
- 8 SUNDEW LN. (PVT.)
- 9 HOLLY LN. (PVT.)

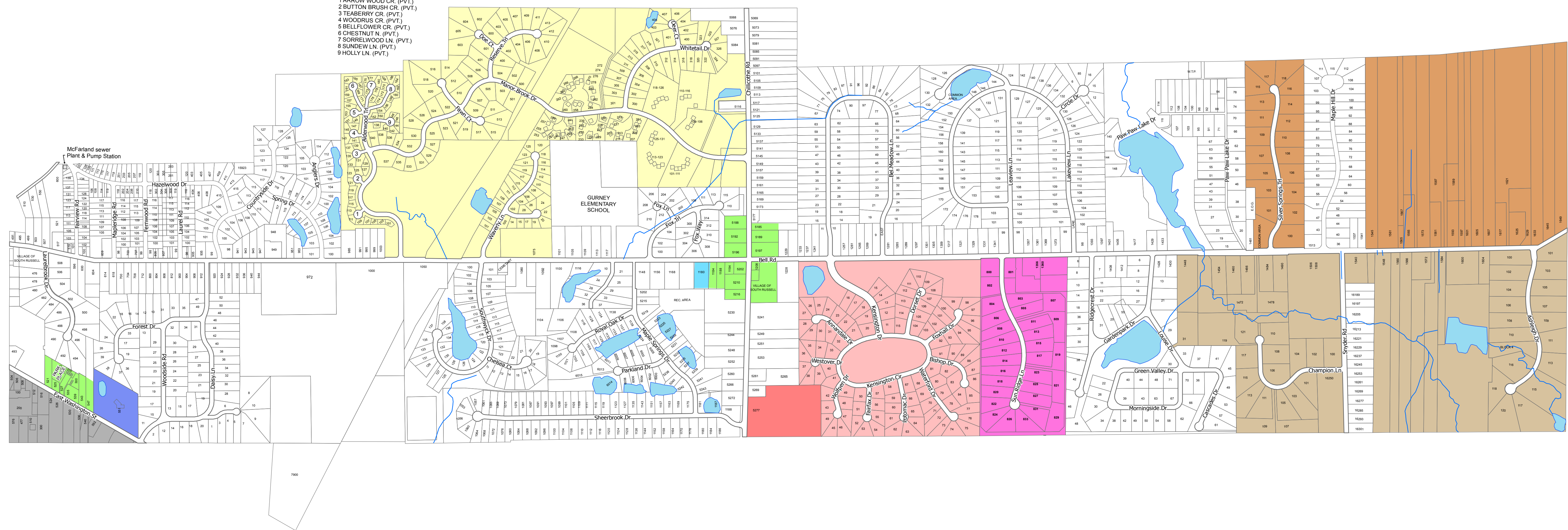

	R-1A: Residential One Family (1 acre)		B-1 & I-1: Business & Light Industrial
	R-1B: Residential One Family (1.5 acres)		B-2: Limited Business
	R-1C: Residential One Family (2 acres)		B-3: Medical Hospital Service
	R-1D: Residential One Family (2.5 acres)		B-4: Limited Offices
	R-2: Residential Multi-family		
	R-3: Elderly Assisted Living		
	RN-1: Residential Neighborhood Development		